

Card Motor Series LAT3



How to Order



LAT3 [] - **10** - **1** **N** **1** **D**

Sensor resolution

Nil	30 μm
F	1.25 μm

Stroke

10	10 mm
20	20 mm
30	30 mm

Actuator cable length

Nil	Without cable
1	1 m
3	3 m
5	5 m

Controller mounting

Nil	Screw mounting
D ^{Note 3)}	DIN rail mounting

I/O cable length^{Note 2)}

Nil	Without cable
1	1 m
3	3 m
5	5 m

Controller^{Note 1)}

Nil	Without controller
N	With controller (NPN)
P	With controller (PNP)

Note 1) Refer to page 3 for detailed specifications of the controller.

Note 2) If "Without controller" has been selected, the I/O cable is also not included.

Therefore it is not possible to select the I/O cable for this option.

If the I/O cable is required, please order separately. (Refer to page 11, "[I/O cable]" for details.)

Note 3) The DIN rail is not included. If the DIN rail is required, please order separately. (Refer to page 4, "DIN rail" and "DIN rail mounting adapter" for details.)

System Construction

Separately sold products^{Note 2)}

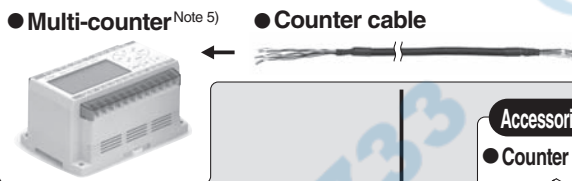

Controller type^{Note 1)}

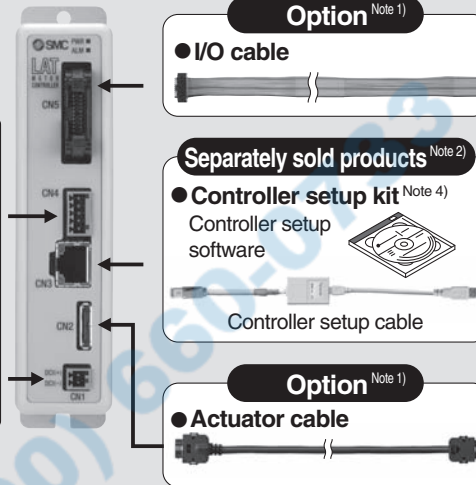

Provided by customer^{Note 3)}

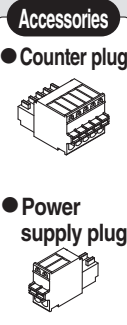
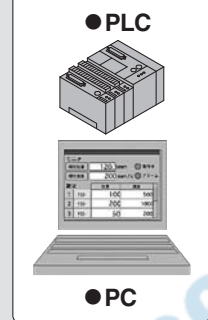
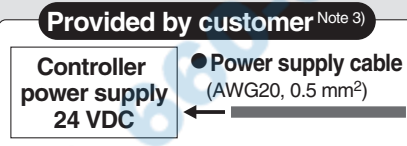

Options (Can be ordered separately or with the motor part number)

No.	Description	Part no.	Remarks
1	Controller	LATC4-□□□□	For details, refer to page 3.
2	Actuator cable	LATH1-□	For details, refer to page 11.
3	I/O cable	LATH2-□	For details, refer to page 11.

Accessories (Supplied with the controller attached to it)

No.	Description	Remarks
1	Power supply plug	For the controller power supply
2	Counter plug	For the multi-counter

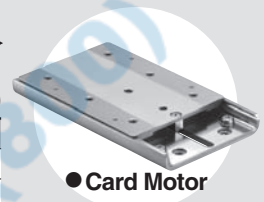

Separately Sold Products

No.	Description	Part no.	Remarks
1	Multi-counter	CEU5□□-□	For details, refer to page 12.
2	Counter cable	LATH3-□	For details, refer to page 11.
3	Controller setup kit	LATC-W1	For details, refer to page 12.

Note 1) It is possible to include options such as controllers and cables in the "How to Order" for the Card Motor. Refer to "How to Order" on this page for details.

Note 2) It is not possible to include separately sold products in the "How to Order" for the Card Motor. Refer to pages 11 and 12, and order separately.

Note 3) Power supply, power supply cables, PLC and PCs should be prepared by the user.

Note 4) These items are used to set the actuator parameters and the operating conditions to the controller and to perform test operations.

Note 5) These items are used to display the table position and to signal active pre-set positions to external devices via digital outputs when measuring the length.